

## DS-2CE56D5T-(A)VPIR3

### HD1080P Turbo HD Outdoor Vandal Proof IR Dome Camera

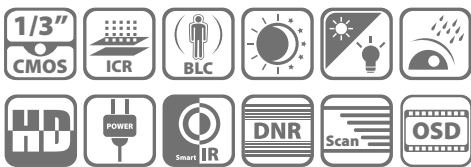

#### Key features

- HD1080P Video Output
- Adopt HDTVl Technology
- True Day/Night
- 2.8 - 12mm vari-focal lens
- OSD menu, 3D DNR, Smart IR
- Up to 40m IR distance
- IP66 weatherproof & Vandal Proof
- Up the Coax(via coaxial cable)
- 120 dB Wide Dynamic Range

#### Dimensions

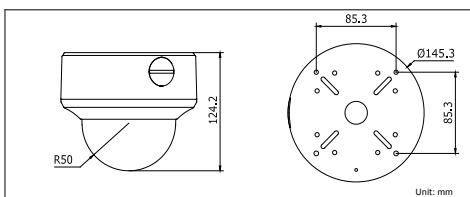

#### Accessories



Video balun  
DS-1H18

#### Available models

DS-2CE56D5T-AVPIR3  
DS-2CE56D5T-VPIR3

| DS-2CE56D5T-(A)VPIR3           |   |
|--------------------------------|---|
| <b>Camera</b>                  |   |
| Image Sensor                   | 1 / 3" Progressive Scan CMOS  |
| Signal System                  | PAL / NTSC  |
| Effective Pixels               | 1920(H)*1080(V)   |
| Min. Illumination              | 0.01 Lux @ (F1.2,AGC ON),0 Lux with IR<br>0.014 Lux @ (F1.4,AGC ON),0 Lux with IR   |
| Shutter speed                  | 1/25(1/30) s to 1/50,000 s  |
| Lens                           | 2.8-12mm @ F1.4<br>Angle of view: 92° - 32°   |
| Lens Mount                     | φ14   |
| Angle Adjustment               | Pan: 0 - 355°, Tilt: 0 - 80°, Rotation: ± 90°   |
| Day & Night                    | ICR   |
| Wide dynamic range             | 120 dB  |
| Synchronization                | Internal synchronization  |
| Video Frame Rate               | 1080p@25fps/1080p@30fps   |
| HD Video Output                | 1 Analog HD output  |
| CVBS Output                    | 1Vp-p Composite Output(75Ω / BNC)   |
| S / N Ratio                    | More than 52dB  |
| <b>Menu</b>                    |   |
| Scene                          | Indoor, Outdoor, Indoor1, LOW-LIGHT   |
| Camera ID                      | On/off (15 characters, position programmable)   |
| AGC                            | Support   |
| D/N Mode                       | Color/BW/EXT  |
| White Balance                  | ATW, AWC-SET, Indoor, Outdoor, Manual   |
| Privacy Mask                   | On/Off, maximum 8 zones   |
| Motion Detection               | On/Off, maximum 4 zones   |
| BLC                            | Support   |
| Anti-flicker                   | On/off  |
| Language                       | English, Japanese, CHN1, CHN2, Korean, German, French, Italian, Spanish, Polish, Russian, Portuguese, Dutch, Turkish, Hebrew and Arabic |
| Function                       | Eclipse, Digital noise reduction, Digital zoom(62x), Slow shutter, Mirror, Defog, Defect pixel correction, SMART D-ZOOM                 |
| <b>General</b>                 |   |
| Working Temperature / Humidity | -20 °C - 60 °C (-4 °F - 140 °F)<br>Humidity 90% or less (non-condensing)  |
| Power Supply                   | 12 VDC ; -A: 12 VDC, 24 VAC   |
| Power Consumption              | 12 VDC: Max. 4.5W ; 24 VAC: Max. 6.5W   |
| Weather Proof Ratings          | IP66  |
| IR Range                       | Up to 40m   |
| Impact Protection              | IEC60068-2-75 test, Eh, 20J; EN50102, up to IK10.   |
| Communication                  | Up the coax(need UTC controller)<br>Protocol: Pelco-C(Coaxitron)  |
| Dimensions                     | φ145.3 × 124.2 mm (φ5.72" × 4.89")  |
| Weight                         | 880 g (1.95 lb)   |